

**SUGGESTED PLANT LIST**

SYMBOL	BOTANICAL NAME	COMMON NAME	SIZE	COMMENT
<b>EVERGREEN TREES</b>				
CL	X CUPROCYPRIS LEYLANDII 'CASTLEWELLAN'	LEYLAND CYPRESS CASTLEWELLAN	8'-10' HT.	B&B
JC	JUNIPERUS CHINENSIS 'SPARTAN'	SPARTAN JUNIPER	6'-7' HT.	B&B
JS	JUNIPERUS SCOPULORUM 'SKYROCKET'	SKYROCKET JUNIPER	6'-7' HT.	B&B
PA	PICEA ABIES	NORWAY SPRUCE	8'-10' HT.	B&B
PS	PINUS STROBILIS	WHITE PINE	8'-10' HT.	B&B
TO	THUJA OCCIDENTALIS 'NIGRA'	DARK AMERICAN ARBORVITAE	8'-10' HT.	B&B
<b>DECIDUOUS AND ORNAMENTAL TREES</b>				
BN	BETULA NIGRA 'DURA HEAT'	RIVER BIRCH	8'-10' HT.	B&B, MULTISTEM
GB	GWYDGO BILOBA	MAIDENHAIR TREE	3-3 1/2' CAL.	B&B
LT	LIRIODENDRON TUJIFERA	TULIP TREE	3-3 1/2' CAL.	B&B
LS	LIQUIDAMBAR STYRACIFLUA	SWEET GUM	3-3 1/2' CAL.	B&B
QP	QUERCUS PALustris 'GREEN PILLAR'	GREEN PILLAR OAK	3-3 1/2' CAL.	B&B
UF	ULMUS 'FRONTIER'	FRONTIER ELM	3-3 1/2' CAL.	B&B
<b>SHRUBS AND ORNAMENTAL GRASSES</b>				
CA	CLETHRA ALNIFOLIA 'HUMMINGBIRD'	SUMMERSWEET	2-2 1/2' HT.	
HM	HAKONECHLOA MACRA 'AUREOLA'	HAKONE GRASS	#2 POT	
HP	HYDRANGEA QUERCIFOLIA 'SNOW QUEEN'	SNOW QUEEN OAKLEAF HYDRANGEA	2-2 1/2' HT.	
IC	ILEX CLABRA 'COMPACT'	INGERSRY	2-2 1/2' HT.	
MS	MISCANTHUS SINENSIS 'MORNING LIGHT'	JAPANESE SILVER GRASS	2-2 1/2' HT.	
PA	PENNESETUM ALOPECUROIDES 'HAMELI'	FOUNTAIN GRASS	#2 POT	
VR	VIBURNUM RHYTHIDOPHYLLODES 'WILLOWWOOD'	WILLOWWOOD VIBURNUM	3'-4' HT.	
<b>PERENNIALS AND GROUNDCOVERS</b>				
AG	ATHYRUM COERULEANGIUM 'PICTUM'	JAPANESE PAINTED FERN	#1 POT	15' O.C.
AP	ADIANTUM PEDATUM	MAIDENHAIR FERN	#1 POT	15' O.C.
AT	ASTILBE 'PURPLE CANDLES'	ASTILBE	#1 POT	15' O.C.
HX	HEDERA HELIX	ENGLISH IVY	#1 POT	10' O.C. ALONG C.L. FENCE
HC	HOSTA 'BLUE CADET'	BLUE CADET HOSTA	#2 POT	15' O.C.
HB	HOSTA 'BIG MAMA'	BIG MAMA HOSTA	#2 POT	24" O.C.
HO	HOSTA 'DANCE WITH ME'	DANCE WITH ME HOSTA	#2 POT	48" O.C.
HH	HEMEROCALLIS 'ROSY RETURNS'	ROSY RETURNS DAYLILY	#1 POT	24" O.C.
IB	IRIS VERSICOLOR 'BLUE FLAG'	BLUE FLAG IRIS	#1 POT	18" O.C.
LA	LIATRIS ASPERA	ROUGH BLAZING STAR	#1 POT	12" O.C.
LM	LIRIOPE MUSCARI 'BIG BLUE'	LILYTURF	#1 POT	12" O.C.
PF	POLYSTICHUM ACROSTICHOIDES	CHRISTMAS FERN	#3 POT	24" O.C.
PR	PEROVSKIA ATRIPLICIFOLIA	RUSSIAN SAGE	#3 POT	36" O.C.
PT	PACHYSANDRA TERMINALIS 'GREEN SHEEN'	GREEN SHEEN PACHYSANDRA	#1 POT	12" O.C.

**PLANTING LEGEND**

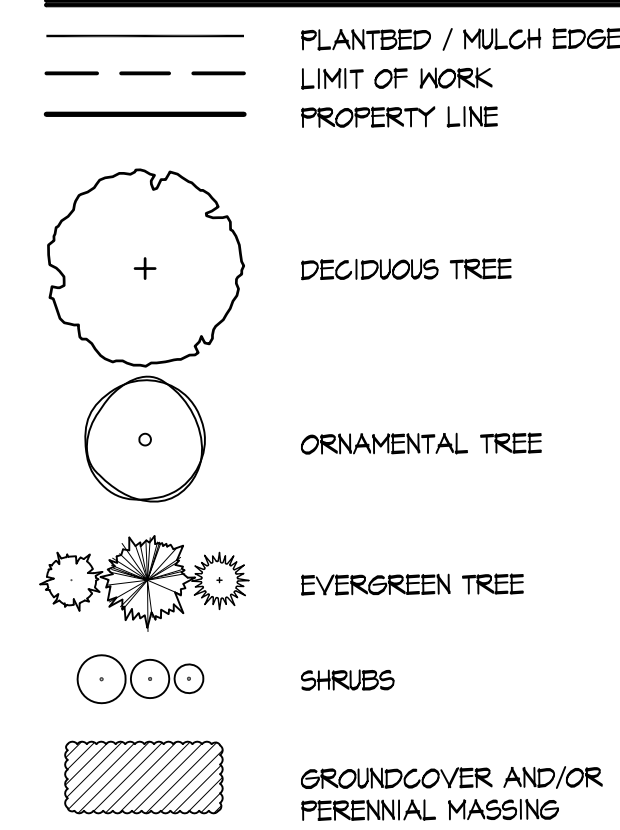

**PLANTING NOTES**

- EXISTING CONDITIONS INFORMATION IS REPRODUCED FROM THE SURVEY PREPARED BY PRECISION LAND SURVEYING, INC. OF SOUTHBOROUGH, MA DATED 09 OCTOBER 2015.
- THE LOCATIONS OF UNDERGROUND UTILITIES SHOWN ARE BASED ON THE SURVEY REFERENCED ABOVE. THE CONTRACTOR SHALL CONTACT DIGSAFE AND THE PROPER LOCAL AUTHORITIES OR RESPECTIVE UTILITY COMPANIES TO CONFIRM THE LOCATION OF ALL EXISTING UTILITIES BEFORE COMMENCING WORK. ANY DAMAGE DUE TO FAILURE OF THE CONTRACTOR TO CONTACT THE PROPER AUTHORITIES SHALL BE BORNE BY THE CONTRACTOR.
- CONTRACTOR SHALL BEGIN MAINTENANCE IMMEDIATELY AFTER PLANTING AND WILL CONTINUE UNTIL FINAL WRITTEN ACCEPTANCE OF PLANT MATERIAL.
- LANDSCAPE ARCHITECT TO FLAG ALL TREES TO BE TRANSPLANTED PRIOR TO CONSTRUCTION START.
- CONTRACTOR SHALL VERIFY ALL TREE REMOVALS AND/OR TRANSPLANTS WITH OWNER'S REPRESENTATIVE PRIOR TO CONSTRUCTION START.
- CONTRACTOR SHALL MAINTAIN POSITIVE DRAINAGE AWAY FROM ALL BUILDING FOUNDATIONS, STRUCTURES, AND PLANTING BEDS.
- MAXIMUM SLOPE WITHIN DISTURBED AREAS SHALL NOT EXCEED 3:1, UNLESS OTHERWISE NOTED.
- THE LANDSCAPE CONTRACTOR SHALL SUPPLY ALL PLANT MATERIALS IN QUANTITIES SUFFICIENT TO COMPLETE ALL PLANTINGS SHOWN ON THIS DRAWING.
- ALL MATERIALS SHALL CONFORM TO THE GUIDELINES ESTABLISHED BY THE AMERICAN NURSERY AND LANDSCAPE ASSOCIATION.
- ALL PLANTS SHALL BEAR THE SAME RELATIONSHIP TO FINAL GRADE AS TO ORIGINAL GRADES BEFORE DIGGING.
- ALL PLANTS TO BE BALLED IN BURLAP OR CONTAINERIZED.
- MULCH FOR PLANTED AREAS TO BE AGED PINE BARK, PARTIALLY DECOMPOSED, DARK BROWN IN COLOR AND FREE OF MOOD CHIPS THICKER THAN 1/4 INCH.
- PLANTING SOIL MIX. LOAM THOROUGHLY INCORPORATED WITH ROTTED MANURE PROPORTIONED 5 C.Y. TO 1 C.Y. OR EQUIVALENT. FERTILIZER ADDED PER RECOMMENDED RATES OF SOILS ANALYSIS.
- THE LANDSCAPE CONTRACTOR SHALL GUARANTEE ALL PLANT MATERIALS FOR ONE (1) FULL YEAR FROM DATE OF ACCEPTANCE.
- ALL PLANT MATERIALS ARE SUBJECT TO THE APPROVAL OF THE LANDSCAPE ARCHITECT, AT THE NURSERY, AND AT THE SITE.
- ALL AREAS OF THE SITE WHICH HAVE BEEN DISTURBED AND NOT OTHERWISE DEVELOPED SHALL BE LOAMED AND SEEDDED WITH A MINIMUM DEPTH OF 6" DEPTH TOPSOIL.
- PLANT SPECIES AS INDICATED IN THE PLANT LIST ARE SUGGESTIONS ONLY. FINAL SELECTION OF SPECIES SHALL OCCUR AT THE TIME OF PLANT PURCHASE, DEPENDING ON AVAILABILITY. PLANT SIZE AND QUANTITY SHALL NOT CHANGE WITHOUT APPROVAL OF OWNER'S REPRESENTATIVE.

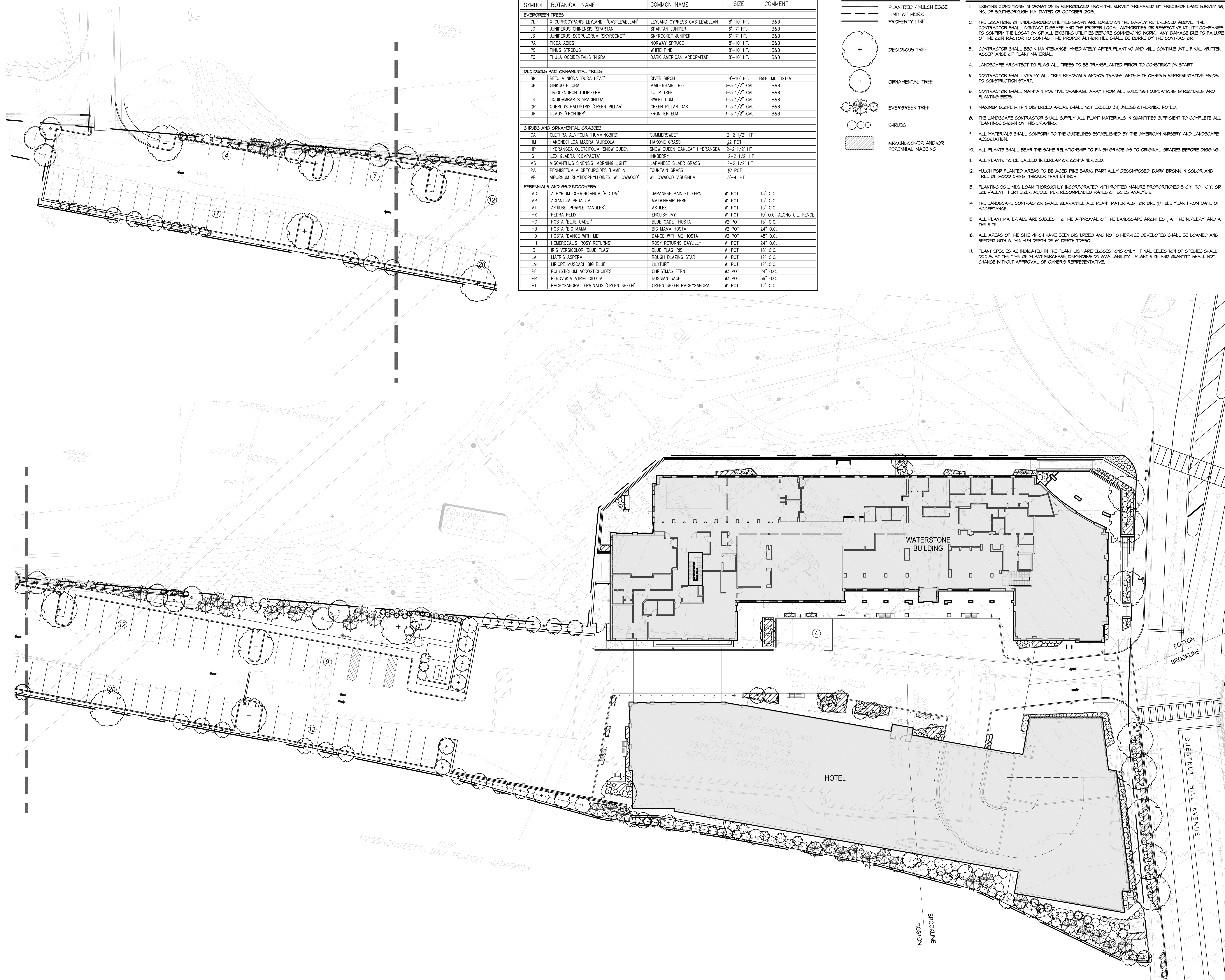

National Development  
Owner  
2310 Washington Street  
Newton Lower Falls, MA 02462  
(617)-527-9800

Cranshaw Construction  
Construction Manager  
2310 Washington Street  
Newton Lower Falls, MA 02462  
(617)-965-7300

Stantec  
Civil Engineer  
Landscape Architect  
226 Causeway Street, 6th Floor  
Boston, MA 02117-2171  
(617)-654-6052

Velitas & Velitas Engineers  
Structural Engineer  
639 Granite Street  
Braintree, MA 02184  
(781)-843-2863

R. W. Sullivan  
MEP / FP Engineer  
529 Main Street Suite 203  
Boston, MA 02129-1107  
(617)-523-8227

Wellesley Design Consultants, Inc.  
Interior Design Consultant  
13 Branch Street, Suite 211  
Methuen, MA 01844  
(978)-965-8185

Jensen Hughes  
Code Consultant  
1661 Worcester Road, Suite 501  
Framingham, MA 01701  
+1 (508)-620-8900

Colburn Guyette  
Kitchen Consultant  
100 Ledgewood Place, Suite 104  
Rockland, MA 02370  
(800)-343-3310

PROJECT NUMBER: 210801221

DATE: 06.12.15

REVISIONS:

SCALE: 1" = 20' - 0"

DRAWING NAME:  
**PLANTING PLAN**

DRAWING NUMBER:  
**L400**